

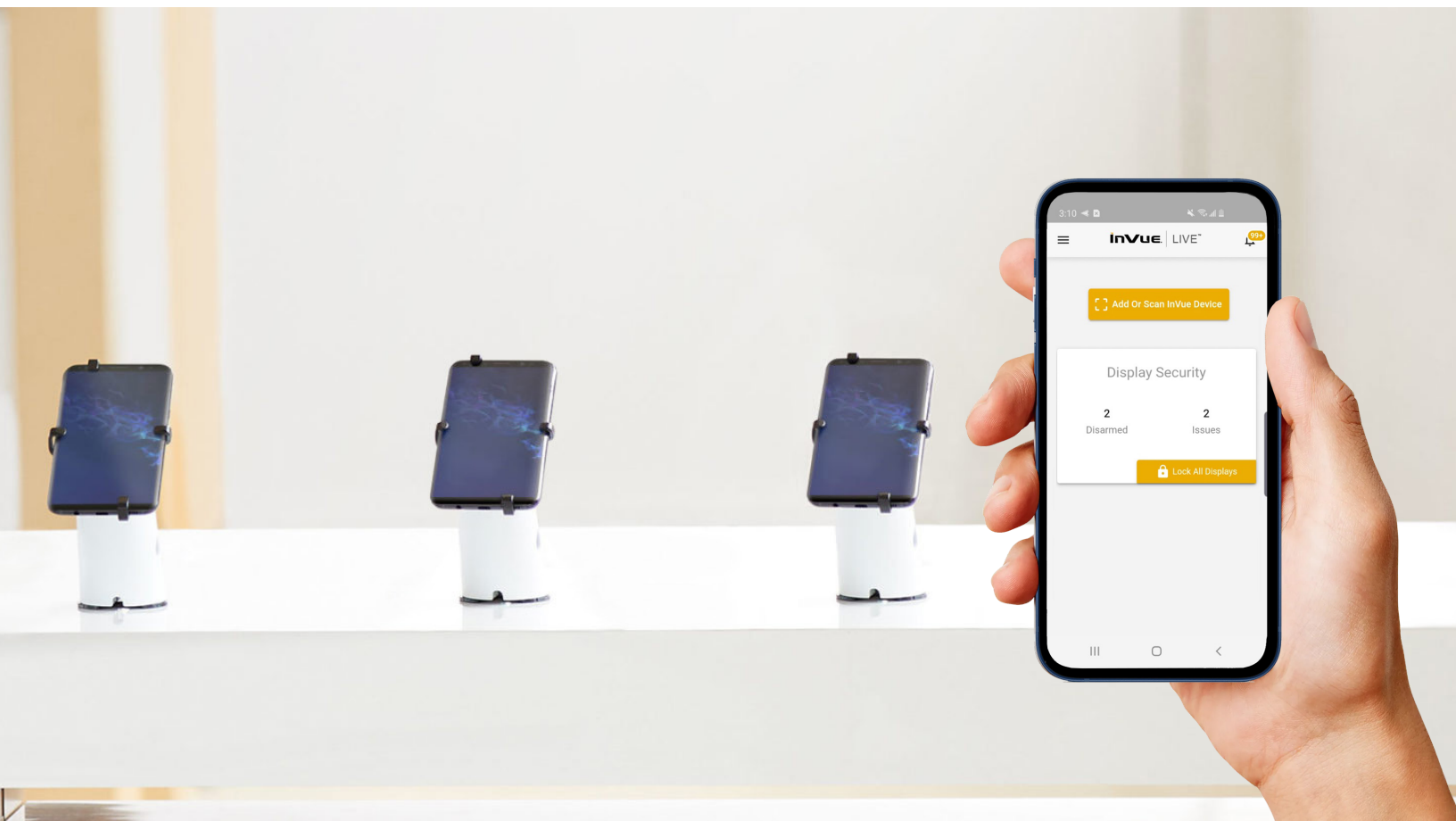

LIVE OnePOD

Security as smart as your phone.



FLEXIBLE EXPERIENCE

Switch from high-security to high-experience on the go.

DIGITAL OPERATIONS

In-app operations, alerts, and self-guided troubleshooting streamlines execution and minimizes downtime.

ACTIONABLE INTELLIGENCE

Measure customer engagement and merchandising performance at any time.



LIVE OnePOD empowers associates to operate and troubleshoot displays at your fingertips.

FEATURES AND BENEFITS

- 1 Consistent look and feel across smartphone and tablet displays
- 2 Compatible with One55, One65 or One60 stands
- 3 Alarm Node provides security audio and light alarms
- 4 Arm, disarm, silence alarms and manage security settings
- 5 Diagnose, troubleshoot and service displays

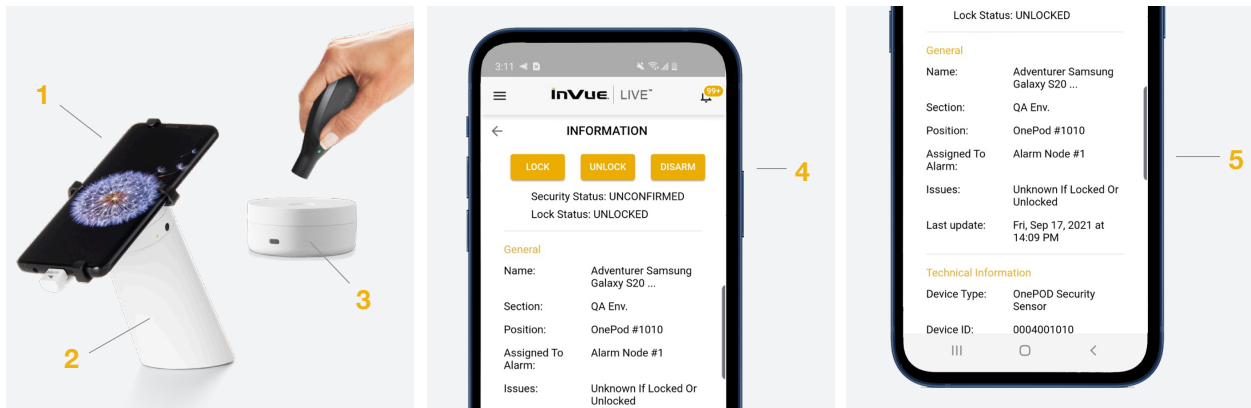

LIVE OnePOD together with InVue's **LIVE Display** software equips store and corporate leaders with control and actionable insights across their enterprise.

For Daily Operations:

- ✓ Intuitive mobile app to control each display
- ✓ Alerts that prompt action
- ✓ Self-guided troubleshooting and diagnosis

For Enterprise Strategy:

- ✓ Remerchandising verification
- ✓ Store operational insights
- ✓ Monitor and report on customer engagement

LIVE ONEPOD INTRODUCES INTELLIGENT SELF-DEFENSE & LOCKDOWN TECHNOLOGY

Optimize store resources and minimize risk using LIVE OnePOD lockdown technologies. Through intelligent self-defense or with InVue's Panic Button, instantly send displays into a high-security lockdown mode when security is threatened.

SCENARIO 1: SECURITY IS THREATENED

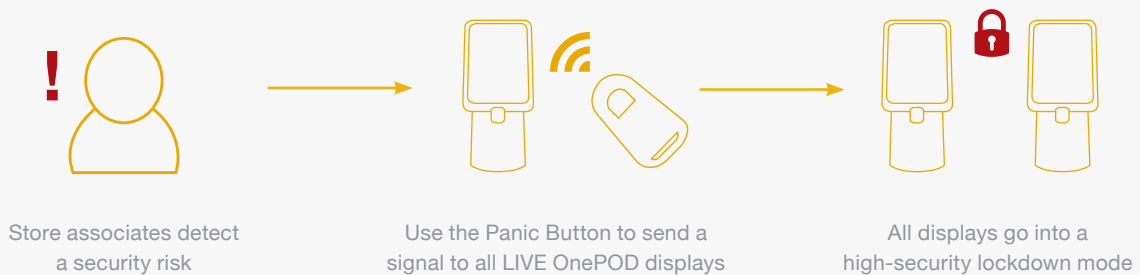

SCENARIO 2: SECURITY IS BREACHED

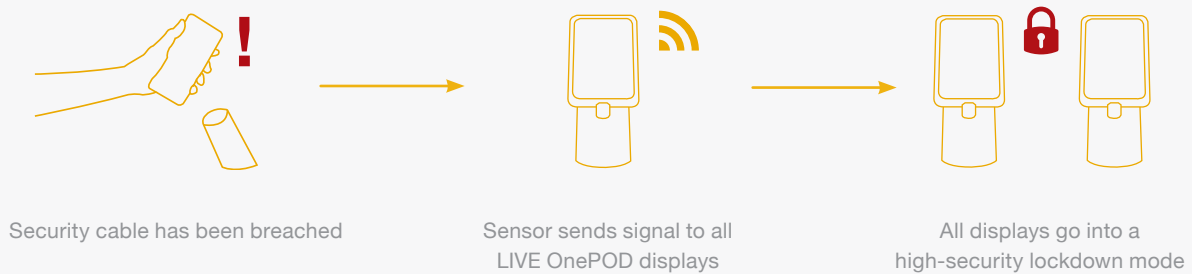

Note: Available only with One60 Auto-Lock stand